

Ciri-36

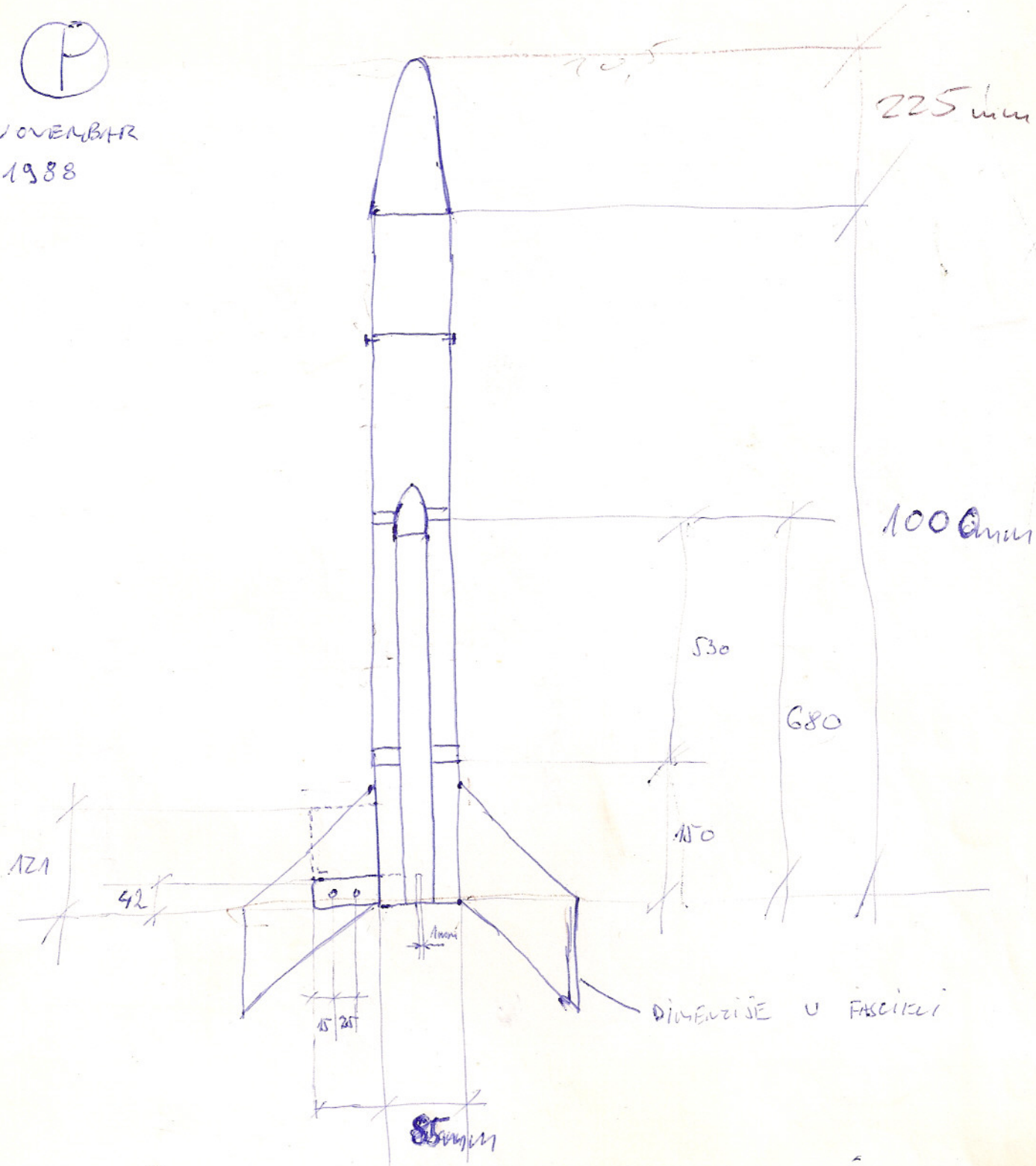

NOVEMBER  
1988



225 mm

1000 mm

530

680

110

AZA

42

15 20

Amorci

DIMENZIJE U FASCICLI

85 mm



$$R_7 = \frac{1}{2} 90^2 \text{ S} \cdot \text{Cz}$$

$$90 \text{ S} = 10 = 10(90 \text{ S} - 1)$$

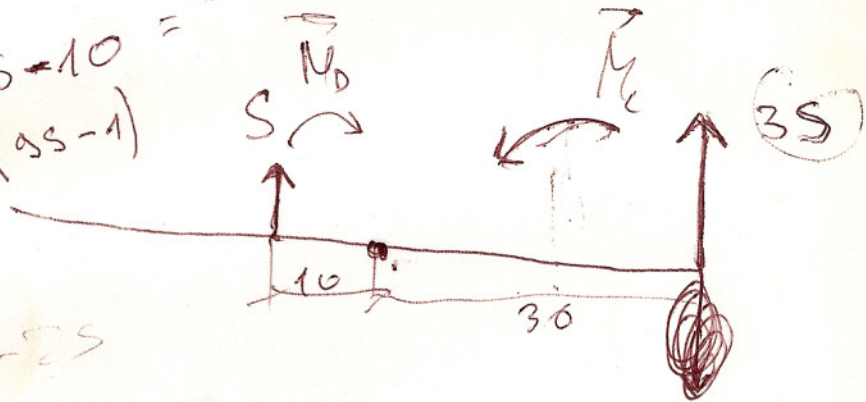

$$90 \text{ S} = 25$$

$$3 \text{ S} \cdot 30 > 10 \text{ S}$$

$$90 \text{ S} > 10 \text{ S}$$

$$M_R = 90 \text{ S} - 10 \text{ S}$$

$$M_R = 80 \text{ S}$$

$$3 \text{ S} \cdot X = 80 \text{ S}$$

Cirzi 36  
STABILIZATOR

Yce

1,3

CTK

10

5

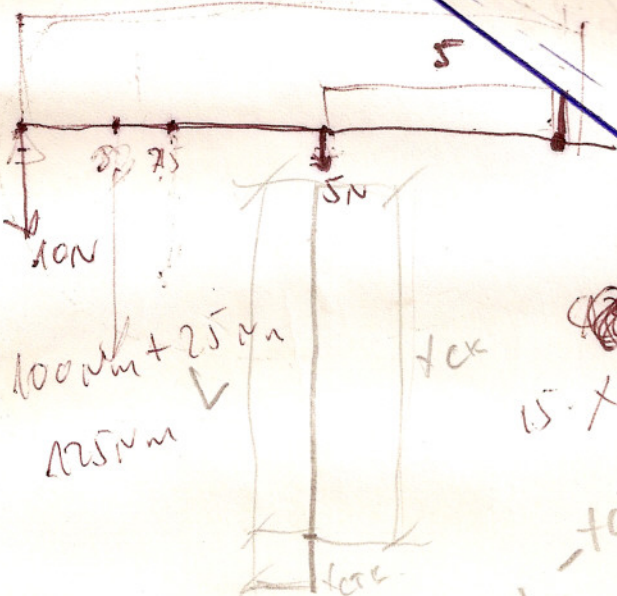

$$100 \text{ Nm} + 25 \text{ Nm}$$

$$125 \text{ Nm}$$

$$15 \cdot X = 125$$

18755 mm<sup>2</sup>

L - xex  
+ xex  
+ xex